

1: GLAZING MATERIAL

- | | | |
|--------------------|--------------------------|--------------------------|
| | INNER | OUTER |
| ACRYLIC DOME | <input type="checkbox"/> | <input type="checkbox"/> |
| POLYCARBONATE DOME | <input type="checkbox"/> | <input type="checkbox"/> |

2: GLAZING COLOR

- | | | |
|--------|--------------------------|--------------------------|
| CLEAR | <input type="checkbox"/> | <input type="checkbox"/> |
| BRONZE | <input type="checkbox"/> | <input type="checkbox"/> |
| WHITE | <input type="checkbox"/> | <input type="checkbox"/> |
| OTHER | <input type="checkbox"/> | <input type="checkbox"/> |

3: FRAME FINISH

- | | |
|-----------------|--------------------------|
| MILL | <input type="checkbox"/> |
| BRONZE ANODIZED | <input type="checkbox"/> |
| CLEAR ANODIZED | <input type="checkbox"/> |
| CUSTOM COLOR | <input type="checkbox"/> |

4: PYRAMID PITCH (OPTIONAL)

- | | |
|------------------------------|--------------------------|
| 22 DEGREE (1/2 WIDTH X .414) | <input type="checkbox"/> |
| 30 DEGREE (1/2 WIDTH X .577) | <input type="checkbox"/> |
| 40 DEGREE (1/2 WIDTH X .839) | <input type="checkbox"/> |

FOR SELF FLASHING SKYLIGHTS PROVIDE
ROUGH OPENING OR ID OF SKYLIGHT DIMENSION

- | | | |
|------|--------|---|
| QTY: | R.O. = | X |
| QTY: | R.O. = | X |
| QTY: | R.O. = | X |
| QTY: | R.O. = | X |

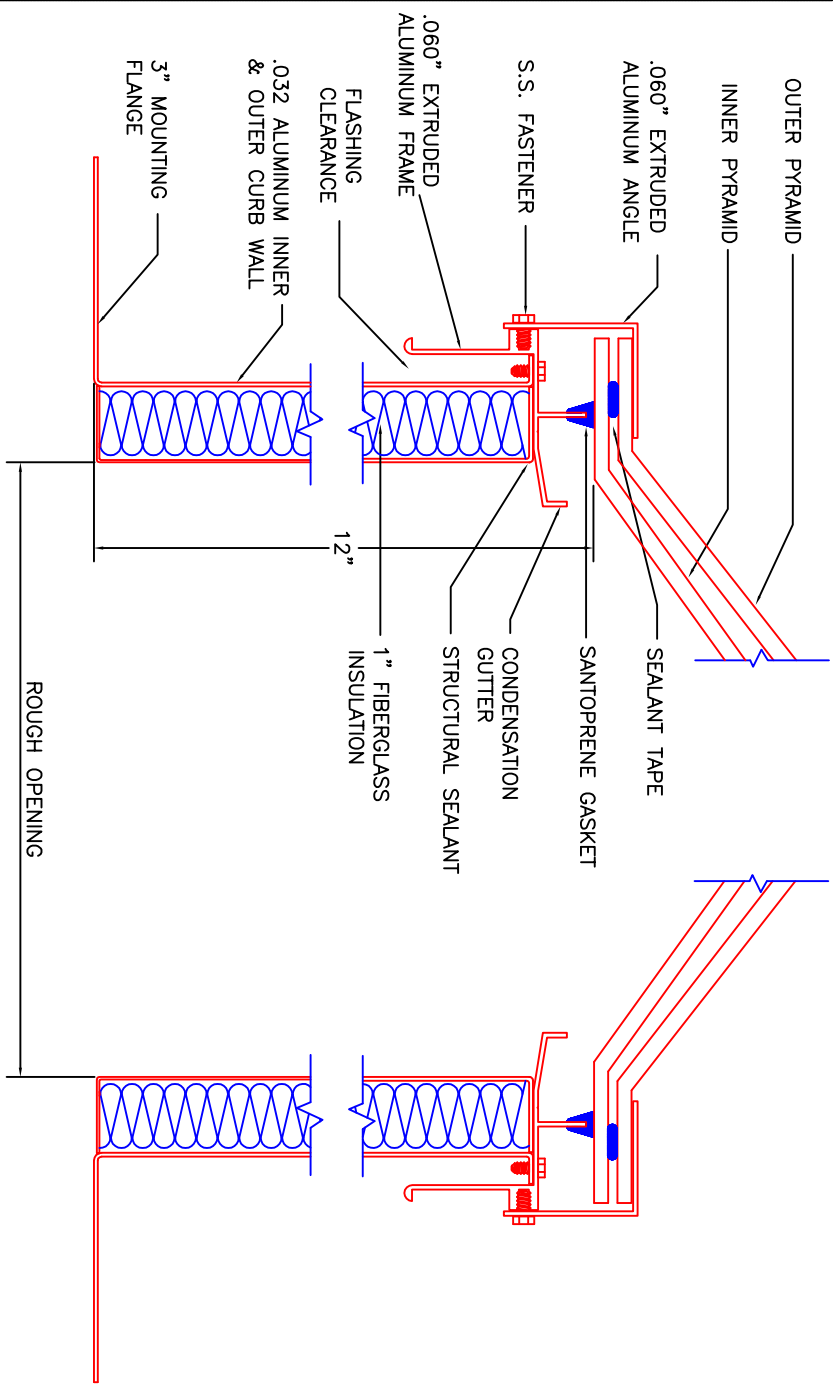

12" INSULATED SELF FLASHING - PYRAMID



AMERICAN SKYLITES
525 113th STREET ARLINGTON, TEXAS 76011
Phone 800.772.7401 Fax 800.445.7282

SPECIFICATIONS

TEST METHOD	TEST PRESSURE	ALLOWED
AIR INFILTRATION ASTM E283	6.24 PSF (50 MPH)	0.03 CFM/FT
WATER PENETRATION ASTM E547/E331	TEST PRESSURE 15.0 PSF	NO LEAKAGE
UNIFORM LOAD ASTM E330	POSITIVE 69.0 PSF NEGATIVE 75.0 PSF	60.0 PSF MIN 40.0 PSF MIN